

Dane techniczne:

Kubatura:	736 m ³
Powierzchnia zabudowy:	144.83 m ²
Powierzchnia całkowita:	255.87 m ²
Powierzchnia netto:	163.95 m ²
Powierzchnia użytkowa:	150.21 m ²
Wymiary domu:	12.65 x 14.94 m
Minimalne wymiary działki:	18.65 x 22.94 m
Wysokość do kalenicy:	8,25 m / 27,06 ft
Powierzchnia dachu:	221.19 m ²
Kąt nachylenia dachu:	25 degrees

Koszty realizacji:

Realizacja stanu surowego otwartego:	43 500
Realizacja stanu surowego zamkniętego:	67 300
Koszt robót wykończeniowych:	72 900
Realizacja domu pod klucz:	140 200

Koszty są podane w cenach netto, należy doliczyć podatek VAT

Materiały:

- Foundations - concrete benches and foundation walls with concrete blocks
- Exterior walls - brick walls - airbricks porotherm 25 + polystyrene + plaster thin
- Ceiling - TERIVA
- Elevation - thin-layer plaster on polystyrene
- Roof - tile

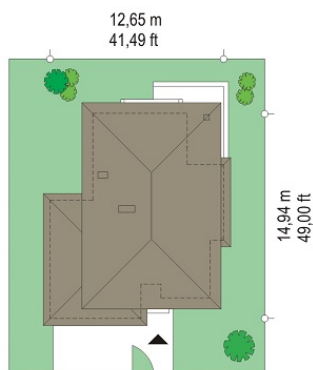
**CENA PROJEKTU: 1070.00 \$**

	Energy-saving package	bezpł.
	Ventilation and fireplace package	90
	Central vacuum package	70
	The electronic version of the project	120
	Solar installation package	70
	Underfloor heating package	80
	Heat pump package	70
	Water jacket package	70
	Boiler for solid fuel package	80
	Air conditioning package	80
	Fencing projects	140
	Septic tanks sealed package	bezpł.

Cassiopeia 4 house plan is a variant version of the house plan Cassiopeia with an enlarged to two positions garage. The building is two-story, a bay window dining room, arcades, balconies and loggias. Modern architecture of the building is also toned, not overdo, what adds elegance to the house. The interior of the villa is divided into a living area on the ground floor - with a combined living and dining room, lounge and partially open kitchen, and bedrooms upstairs. On the ground floor there is also a garage and a boiler room. On the first floor has managed to save a separate apartment for parents, with its own bathroom and dressing room, and children's bedrooms with a bathroom accessible from the hall. Additionally, a fourth room, can be freely arranged - a bedroom, office, or, for example laundry and drying room. The house is full of light, has a lot of glass from floor to ceiling - especially in the open to the garden living room. Partly covered terrace is a real extension of the house Cassiopeia 4 house plan has also a mirror version.

Rzuty:



Elewacje:

