

## Dane techniczne:

|                            |                       |
|----------------------------|-----------------------|
| Kubatura:                  | 930 m <sup>3</sup>    |
| Powierzchnia zabudowy:     | 193.46 m <sup>2</sup> |
| Powierzchnia całkowita:    | 320.55 m <sup>2</sup> |
| Powierzchnia netto:        | 220.91 m <sup>2</sup> |
| Powierzchnia użytkowa:     | 211.78 m <sup>2</sup> |
| Wymiary domu:              | 13.65 x 17.54 m       |
| Minimalne wymiary działki: | 21.65 x 25.54 m       |
| Wysokość do kalenicy:      | 8,27 m / 27,12 ft     |
| Powierzchnia dachu:        | 293.29 m <sup>2</sup> |
| Kąt nachylenia dachu:      | 25 degrees            |

## Koszty realizacji:

|  |         |
|--|---------|
| Realizacja stanu surowego otwartego:   | 61 200  |
| Realizacja stanu surowego zamkniętego: | 87 900  |
| Koszt robót wykończeniowych:           | 95 400  |
| Realizacja domu pod klucz:             | 183 300 |

Koszty są podane w cenach netto, należy doliczyć podatek VAT

## Materiały:

- Foundations - concrete bench and foundation walls with concrete blocks
- External walls - brick walls -porotherm 25 blocks + polystyrene + thin-layer plaster
- Ceiling - Teriva
- Elevation - thin-layer plaster on polystyrene
- Roof - ceramic tile

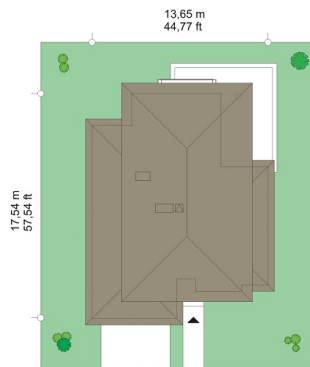
**CENA PROJEKTU: 1140.00 \$**

|  |                                       |        |
|--|---------------------------------------|--------|
|  | Energy-saving package                 | bezpł. |
|  | Ventilation and fireplace package     | 90     |
|  | Central vacuum package                | 70     |
|  | The electronic version of the project | 120    |
|  | Solar installation package            | 70     |
|  | Underfloor heating package            | 80     |
|  | Heat pump package                     | 70     |
|  | Water jacket package                  | 70     |
|  | Boiler for solid fuel package         | 80     |
|  | Air conditioning package              | 80     |
|  | Fencing projects                      | 140    |
|  | Septic tanks sealed package           | bezpł. |

Cassiopeia 5 house plan is a variant version of the popular basic Cassiopeia. The house has been greatly enlarged and became comfortable storey villa with double garage. Storey elongated core of the house covered by a hipped roof and is surrounded by a outhouses. The entire body has a nice shape, enriched with large glass panels, wall claddings, bay windows and arcades. The whole creates a modern toned appearance. The interior of the building is divided into daily part on the ground floor and bedrooms upstairs. The ground floor is mainly combined of living room, dining room and hall. Exposed representative stairs, fireplace, corner balcony window to the terrace and the arcade - these elements raising the attractiveness of the interior. Large kitchen with an additional place for breakfast and pantry is partially open to the dining room and lounge. On the ground floor there are also space for an extra room-office, or guest bedroom and a garage for two cars and a boiler room. On the first floor there are four rooms, including parents' bedroom with separate bathroom and dressing room, large bathroom and laundry room. In addition, there are attics - over the floor, and over the garage and boiler room. Cassiopeia 5 includes all the rooms you would only require from such large comfortable house. House is also energy efficient. House is energy efficient - has a very good insulation and new technology, which reduces the cost of maintaining house. This project is available in the mirror version and several other versions: the base (Cassiopeia), in the twinned (Cassiopeia 2) version of the area. 172.7 m<sup>2</sup> (Cassiopeia 3) cheaper in the implementation version (Cassiopeia 4), in the largest version (Cassiopeia 6).

## Rzuty:



## Elewacje:

