

## Dane techniczne:

Kubatura:	849 m <sup>3</sup>
Powierzchnia zabudowy:	245.48 m <sup>2</sup>
Powierzchnia całkowita:	279.98 m <sup>2</sup>
Powierzchnia netto:	165.21 m <sup>2</sup>
Powierzchnia użytkowa:	159.01 m <sup>2</sup>
Wymiary domu:	19.86 x 16.04 m
Minimalne wymiary działki:	27.86 x 25.64 m
Wysokość do kalenicy:	6,81 m/22,34 ft
Powierzchnia dachu:	356.6 m <sup>2</sup>
Kąt nachylenia dachu:	30 degrees

## Koszty realizacji:

Realizacja stanu surowego otwartego:	69 190
Realizacja stanu surowego zamkniętego:	99 500
Koszt robót wykończeniowych:	87 290
Realizacja domu pod klucz:	186 780

Koszty są podane w cenach netto, należy doliczyć podatek VAT

## Materiały:

- Foundations - concrete bench and foundation walls with concrete blocks
- External walls - brick walls -porotherm 25 blocks + polystyrene + thin-layer plaster
- Ceiling - monolithic reinforced concrete
- Elevation - thin-layer plaster on polystyrene
- Roof - tile



## CENA PROJEKTU: 1590.00 \$

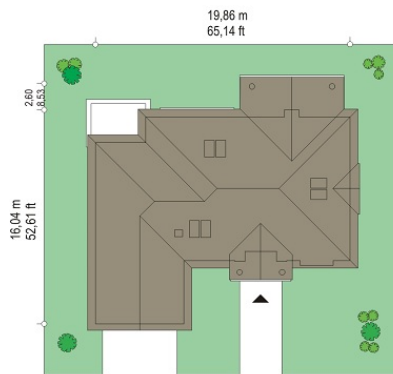

	Energy-saving package	bezpł.
	Ventilation and fireplace package	90
	Central vacuum package	70
	The electronic version of the project	120
	Solar installation package	70
	Underfloor heating package	80
	Heat pump package	70
	Water jacket package	70
	Boiler for solid fuel package	80
	Air conditioning package	80
	Fencing projects	140
	Septic tanks sealed package	bezpł.

Villa park is a stylish single-family villa, designed for a family of 4-5 people. House is one-storeyed with a small attic. This is a variant version of house with series of Villa park, but this time the villa is smaller - has almost the same functions and number of rooms, but on the usable space of 160 m<sup>2</sup> plus garage. Spreading body of house covered by hipped roof connects the main body, and built another garage in the front and a large covered terrace facing the garden. Front elevation is decorated with elegant portico entrance with columns. House is decorated in the style of suburban residence. Architectural details emphasize the classic style of the house. The interior was designed in modern and functional style. The living area is a single space consisting of living room, dining room, hall and kitchen. Above the living room is designed open space - emptiness. Above the living room is provided mezzanine. From the hall and the living room we see the representative stairs to the attic. The second part of the house occupied bedroom, separated from the living area. There is parents' suite with bathroom and dressing room and own separate terrace, and two children's bedrooms with a bathroom. In the attic is provided extra room - for example for office or another bedroom. In the utility part we have designed a boiler room and a garage for two cars. We have tried to conserve space and squeeze it as much as possible. In result we created comfortable and economical house from which future owners will be proud, and the costs of construction and maintenance will be reasonable. Villa Park has been applied to energy-efficient solutions, the cost of living in this mini-mansion will therefore remained at reasonable level. is a stylish single-family villa, designed for a family of 4-5 people. House is one-storeyed with a small attic. This is a variant version of house with series of Villa park, but this time the villa is smaller - has almost the same functions and number of rooms, but on the usable space of 160 m<sup>2</sup> plus garage. Spreading body of house covered by hipped roof connects the main body, and built another garage in the front and a large covered terrace facing the garden. Front elevation is decorated with elegant portico entrance with columns. House is decorated in the style of suburban residence. Architectural details emphasize the classic style of the house. The interior was designed in modern and functional style. The living area is a single space consisting of living room, dining room, hall and kitchen. Above the living room is designed open space - emptiness. Above the living room is provided mezzanine. From the hall and the living room we see the representative stairs to the attic. The second part of the house occupied bedroom, separated from the living area. There is parents' suite with bathroom and dressing room and own separate terrace, and two children's bedrooms with a bathroom. In the attic is provided extra room - for example for office or another bedroom. In the utility part we have designed a boiler room and a garage for two cars. We have tried to conserve space and squeeze it as much as possible. In result we created comfortable and economical house from which future owners will be proud, and the costs of construction and maintenance will be reasonable. Villa Park has been applied to energy-efficient solutions, the cost of living in this mini-mansion will therefore remained at reasonable level.

## Rzuty:



## Elewacje:



MG Projekt Pracownia Architektoniczna s.c. ul. Uczniowska 14 03-112 Warszawa  
 tel.: 22 676 66 83, 22 676 66 88, fax: 22 676 66 82, mob.: 600 392 884,  
 tylko przedstawiciele 606 200 136, [www.mgprojekt.com.pl](http://www.mgprojekt.com.pl),  
[mgprojekt@mgprojekt.com.pl](mailto:mgprojekt@mgprojekt.com.pl)

MG Projekt