

## Dane techniczne:

Kubatura:	521 m <sup>3</sup>
Powierzchnia zabudowy:	90.25 m <sup>2</sup>
Powierzchnia całkowita:	146.28 m <sup>2</sup>
Powierzchnia netto:	122.6 m <sup>2</sup>
Powierzchnia użytkowa:	117.5 m <sup>2</sup>
Wymiary domu:	9.5 x 15.2 m
Minimalne wymiary działki:	17.61 x 22.2 m
Wysokość do kalenicy:	8,42 m / 27,62 ft
Powierzchnia dachu:	184.86 m <sup>2</sup>
Kąt nachylenia dachu:	45 degrees

## Koszty realizacji:

Realizacja stanu surowego otwartego:	22 000
Realizacja stanu surowego zamkniętego:	36 900
Koszt robót wykończeniowych:	50 500
Realizacja domu pod klucz:	87 400

Koszty są podane w cenach netto, należy doliczyć podatek VAT

## Materiały:

**Traditional technology:**

- Foundations - Concrete benches and foundation walls with concrete blocks
- External walls - brick walls - silicate blocks + polystyrene + plaster thin
- Ceiling - wooden or Teriva
- Elevation - thin-layer plaster on polystyrene
- Roof - tile

**The prefabricated technology of company Mabudo:**

- Foundations - feet and foundations concrete
- External walls - layered prefabricated - concrete and styrofoam
- Ceiling - prefabricated wooden
- Rafter - prefabricated - wood
- Elevations - plaster
- Roof - tile

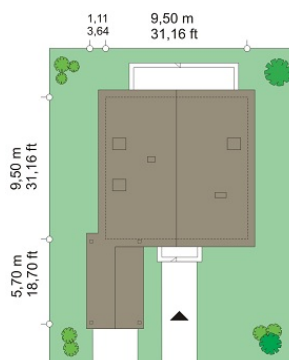
**CENA PROJEKTU: 970.00 \$**

	Energy-saving package	bezpł.
	Ventilation and fireplace package	90
	Central vacuum package	70
	The electronic version of the project	120
	Solar installation package	70
	Underfloor heating package	80
	Heat pump package	70
	Water jacket package	70
	Boiler for solid fuel package	80
	Air conditioning package	80
	Fencing projects	140
	Septic tanks sealed package	bezpł.

John house plan is one-storey detached house with attic forte family of four to six people. This house is built on a square plan 9,5x9,5 m, and covered by a gabled roof, with an added carport. The essence of this house is simple solid in combination of well-chosen proportional and an interesting details. This building was designed in two technologies to choose: traditional - brick or prefabricated - from the prefabricate elements imported from a factory and assembled by a crane. Depending on whether the investor decides to build John house on their own, or outsource the construction to the company Mabudo ([www.mabudo.pl](http://www.mabudo.pl); (43) 823 41 41). The interior of house is divided into a living part of the ground floor and bedrooms on the attic. At the bottom, besides a large living room with a dining area, hall and open kitchen, an extra room - study or bedroom, wc with shower, and a boiler room was designed. On the attic there are three comfortable bedrooms and a large bathroom. Master bedroom has an additional dressing room. In the children's bedrooms wardrobes are built in. Before the house, from the front additionally there is a carport, which is quite easy to turn - if necessary - to the garage. The house has a simple construction, is easy in building and is inexpensive in later use. John house plan is also available in a mirror version and with Teriva ceiling.

## Rzuty:



## Elewacje:

